

# WELCOME TO SOESTDUINEN







SURROUNDINGS OF SOESTDUINEN

# LOCATION, LOCATION, LOCATION

## SOESTDUINEN, THE NETHERLANDS

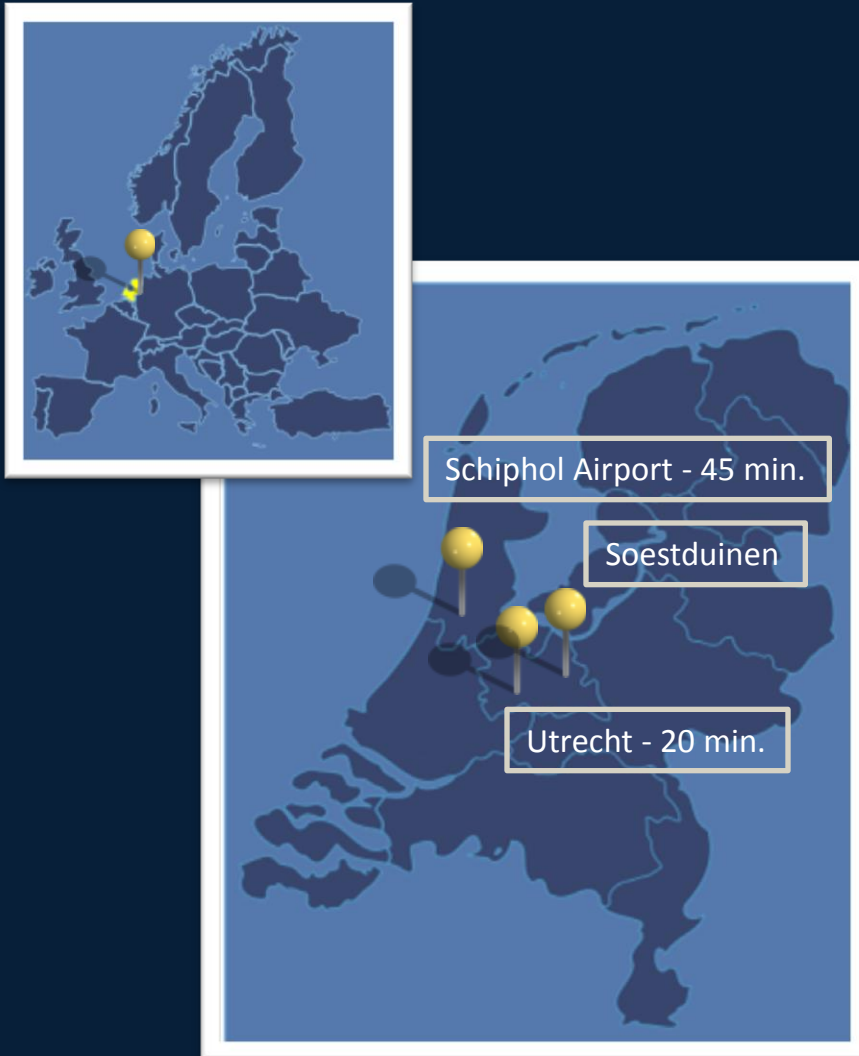

- Situated in the centre of the Netherlands.
- Close to several major cities. Just 15 minutes from the city of Amersfoort, 9 miles from the shopping district of Utrecht.
- Amsterdam Airport Schiphol is 45 minutes away. There you have direct access by train to Amsterdam, Brussels and Oberhausen.
- Rotterdam-The Hague airport is a 70 minutes drive from Soestduinen.

# MUST-SEES

ATTRACTIONS & MUSEA IN AND AROUND SOESTDUINEN







**Palace Soestdijk - Former palace of the Dutch Royal Family**



**DierenPark Amersfoort (ZOO)**



**National Military Museum**



**Institute for Sound and Vision**





Amersfoort



Utrecht – including the cathedral's Dom Tower



Railway Museum

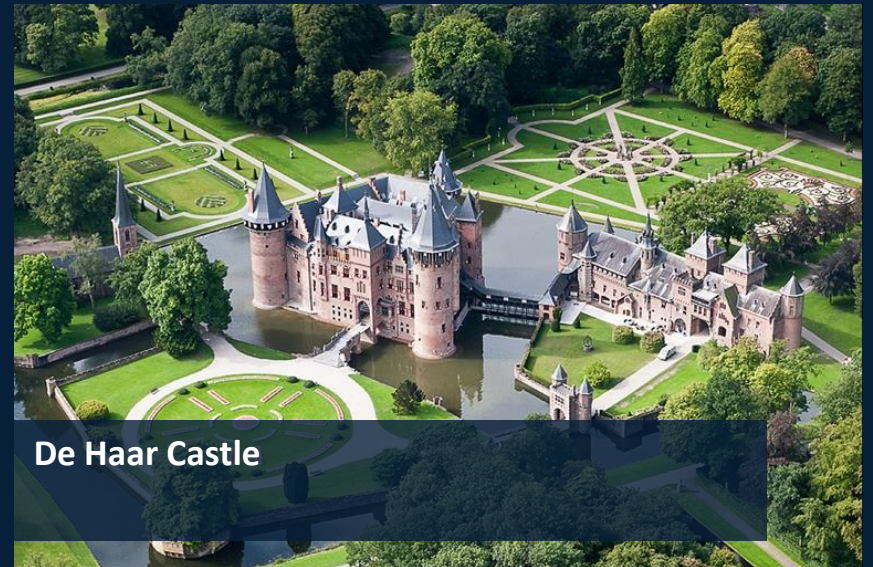

De Haar Castle



# JOIN US IN HILTON ROYAL PARC SOESTDUINEN



**Hilton**

ROYAL PARC SOESTDUINEN

# HOTEL FACILITIES & SERVICES

## AT A GLANCE

- 113 spacious guest rooms all equipped with air-conditioning, a balcony, bath and shower, and wireless internet
- 21 multifunctional meeting rooms featuring natural daylight and a maximum capacity for up to 500 delegates
- Over 1,800m<sup>2</sup> meeting space
- Unique Nassau Pavilion Ballroom with a spectacular view over the 9-hole golf course
- Health club including fitness facilities, swimming pool, sauna, beauty treatments, Turkish steam bath and solarium
- 250 complimentary parking spaces available
- Restaurant Royal Parc for breakfast, lunch, high tea and dinner. 24-hour Room Service
- Sample a great range of drinks and tasty Dutch snacks in the Orange Bar
- Situated in serene woodlands, overlooking a 9-hole golf course with putting green and driving range and outdoor tennis court



# ACCOMMODATION

HILTON ROYAL PARC SOESTDUINEN



# ACCOMMODATION

## 113 ROOMS & SUITES

### In-room facilities

The Guest Rooms have a twin or king-size bed and a private balcony. The amenities include air-conditioning and tea and coffee making facilities. All rooms offer large bathrooms with separate bathtubs and showers.

The hotel offers Guest Rooms with golf view, overlooking the golf course.

The Deluxe Rooms offer floor-to-ceiling windows and a bathrobe, slippers and complimentary water.

### King Suites

Step into our stylish and spacious King suite. The separate living area provides a homely touch, allowing you more room to relax, while all the benefits of our Deluxe Room are included for a relaxed and memorable stay.





# HEALTH CLUB

HILTON ROYAL PARC SOESTDUINEN



# HEALTH CLUB

## STAY AND RELAX

Join us in our sport and wellness center, with a fully equipped fitness center, spa and treatment facilities.

- Solarium and sauna
- Beauty Center - Treat yourself to a Thalgo Facial treatment or indulge in total relaxation with a hot stone massage

### Swimming Pool

15-meter Roman style pool offers an invigorating and relaxing escape. Set at 31 degree Celsius, the pool is ideal for exercising and you can relax on one of the many poolside beds. Visit the dry Swedish sauna or Turkish steam bath.





# RESTAURANT ROYAL PARC

HILTON ROYAL PARC SOESTDUINEN



# RESTAURANT ROYAL PARC

## AT A GLANCE

- Offering a delicious range of local and international dishes with table preparations
- Serving breakfast, lunch, dinner, high tea and drinks
- Outdoor sunny terrace with a view on the golf course from May until October
- Capacity of the restaurant is 85 covers, capacity of the terrace is 70 covers
- Exciting Gin & Tonic menu
- Special offers during certain holidays with specifically designed menus and live entertainment





# CONFERENCE & MEETINGS

AT HILTON ROYAL PARC SOESTDUINEN



AMERICAS • EUROPE • MIDDLE EAST • AFRICA • ASIA • AUSTRALASIA

# CONFERENCE & EVENTS

## AT A GLANCE

Whatever the occasion – meeting, large conference, multiple day training, wedding or family dinner – Hilton Royal Parc Soestduinen has the expertise and range of venues to bring your event to life.

- 21 multifunctional meeting rooms featuring natural daylight and a maximum capacity for up to 500 delegates
- Over 1,800m<sup>2</sup> convention space including a Business Centre (with photocopier and printer)
- Dedicated Hilton Meeting Host for assistance during your meeting to ensure you have a successful event
- We offer audiovisual equipment rental, video conferencing is available and the hotel has wireless internet access





# CONFERENCE & EVENTS

## CAPACITIES

	Floor	Dimensions L x W x H (m)	Theatre	Classroom	Cabaret	Boardroom	U-Shape	Banquet	Dinner Dance	Air-conditioning	3 Phase Power	Blackout	Daylight
Nassau Paviljoen	Ground	Circular m Diam. 20 x 6.5	320	120	160	—	—	220	130	•	•	•	•
Willem I	Ground	21 x 13 x 2.6	230	100	120	60	50	150	80	•	•	•	•
Willem II	Ground	8 x 10 x 2.6	70	28	32	26	26	40	—	•	•	•	•
Willem III	Ground	13 x 10 x 2.6	90	40	48	36	32	50	—	•	•	•	•
Willem I + II	Ground	—	300	124	152	—	—	190	—	•	•	•	•
Willem II + III	Ground	21 x 10 x 2.6	220	70	88	62	54	110	—	•	•	•	•
Willem I + II + III	Ground	485m <sup>2</sup>	500	164	210	—	—	250	210	•	•	•	•
Beatrixzaal	+1	Half Circle Diam. 20 x 6.5	200	120	120	48	50	130	70	•	•	•	•
Willem Alexander I	-1	7.5 x 5 x 2.6	25	12	14	12	14	—	—	—	•	•	•
Willem Alexander II	-1	7.5 x 5 x 2.6	25	12	14	12	14	—	—	—	•	•	•
Johan Friso I	-1	7.5 x 5 x 2.6	25	12	14	12	14	—	—	—	•	•	•
Johan Friso II	-1	7.5 x 5 x 2.6	25	12	14	12	14	—	—	—	•	•	•
Constantijn I	-1	7.5 x 5 x 2.6	25	12	14	12	14	—	—	—	•	•	•
Constantijn II	-1	7.5 x 5 x 2.6	25	12	14	12	14	—	—	—	•	•	•
Prinzenzaal I + II (3)	-1	7.5 x 10 x 2.6	50	24	32	32	22	—	—	—	•	•	•
Floris	-1	7.5 x 10 x 2.6	50	24	32	32	22	—	—	—	•	—	•
Bernhard	-1	7.5 x 10 x 2.6	50	24	32	32	22	—	—	—	•	—	•
Juliana Lounge	-1	Half circle Diam. 20 x 6.5	140	70	112	112	40	110	70	—	•	•	—
Maurits 1 - 6	-1	9 x 4 x 2.6	25	12	16	16	16	—	—	•	•	•	•
Maxima	-1	9 x 4 x 2.6	—	—	—	12	—	—	—	•	•	•	•
Amalia	-1	7.7 x 5	25	12	16	16	16	—	—	•	•	•	•

# CONFERENCE & EVENTS

## FLOOR PLAN

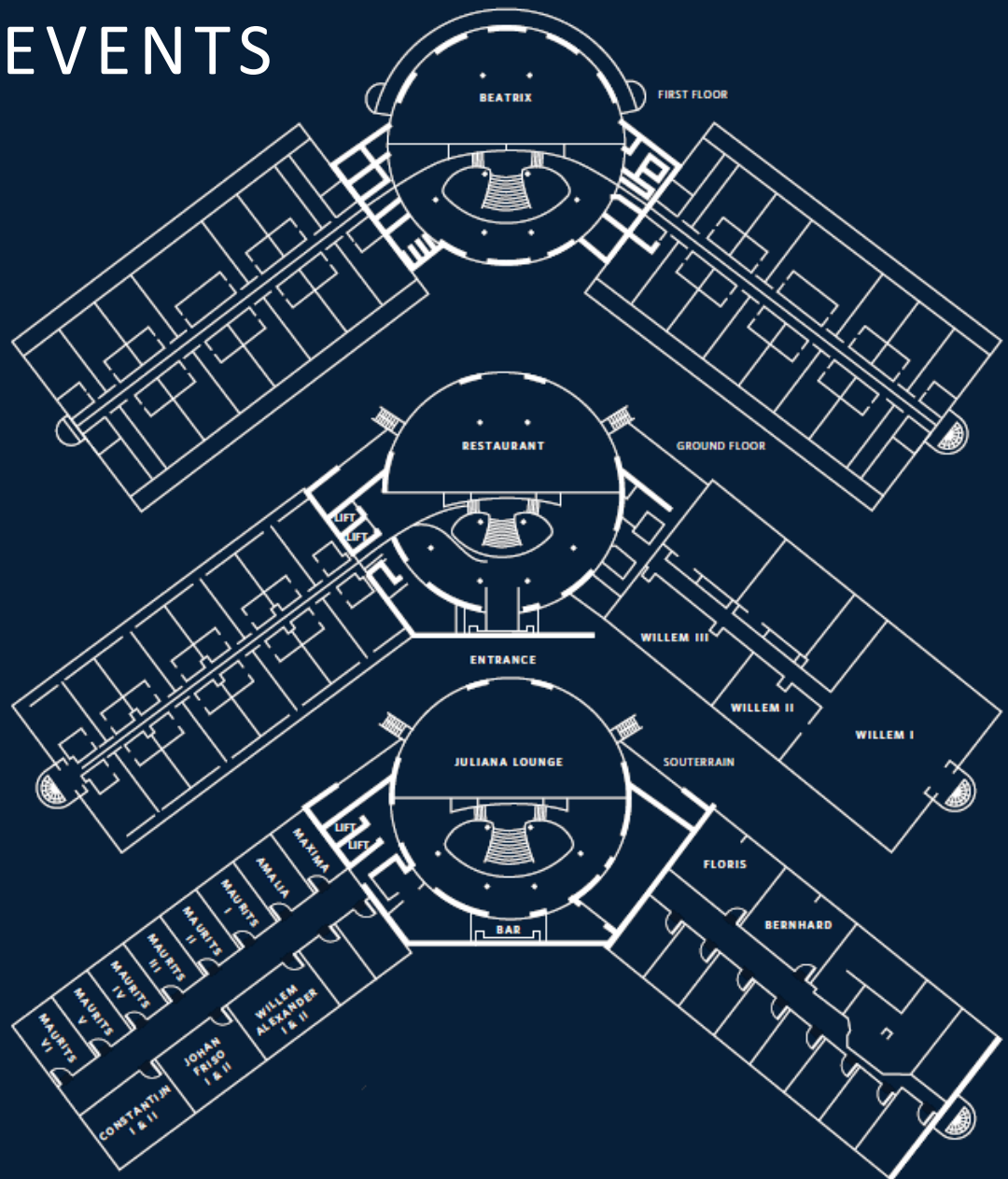
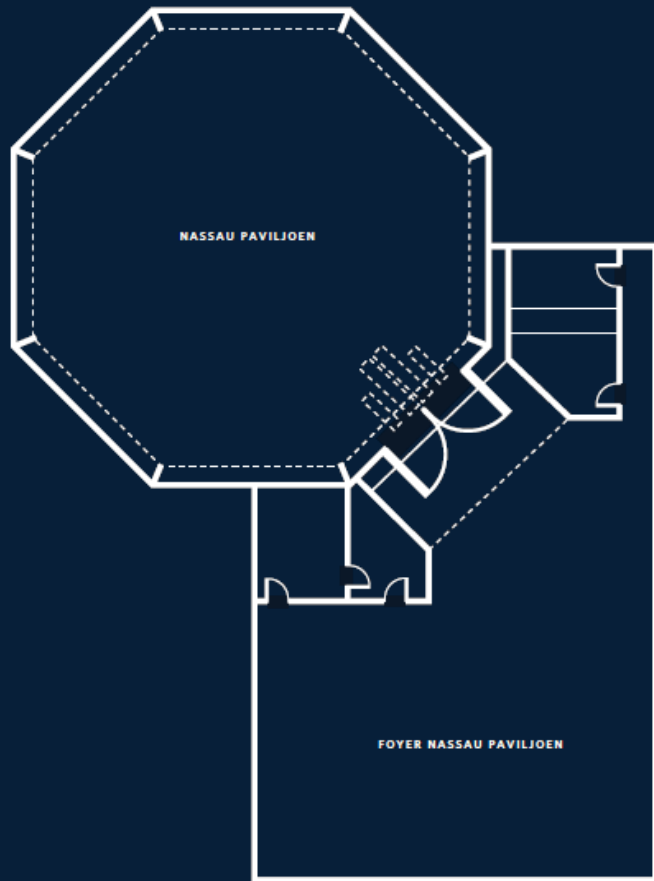



**Nassau Paviljoen**



**Beatrix**



**Bernard**



**Maxima**



HOST YOUR EVENT

AT HILTON ROYAL PARC SOESTDUINEN



AMERICAS • EUROPE • MIDDLE EAST • AFRICA • ASIA • AUSTRALASIA



Outside Teambuilding Activities



9-hole Golf Course, Par 3 - Golf Clinic



Boxing Clinic

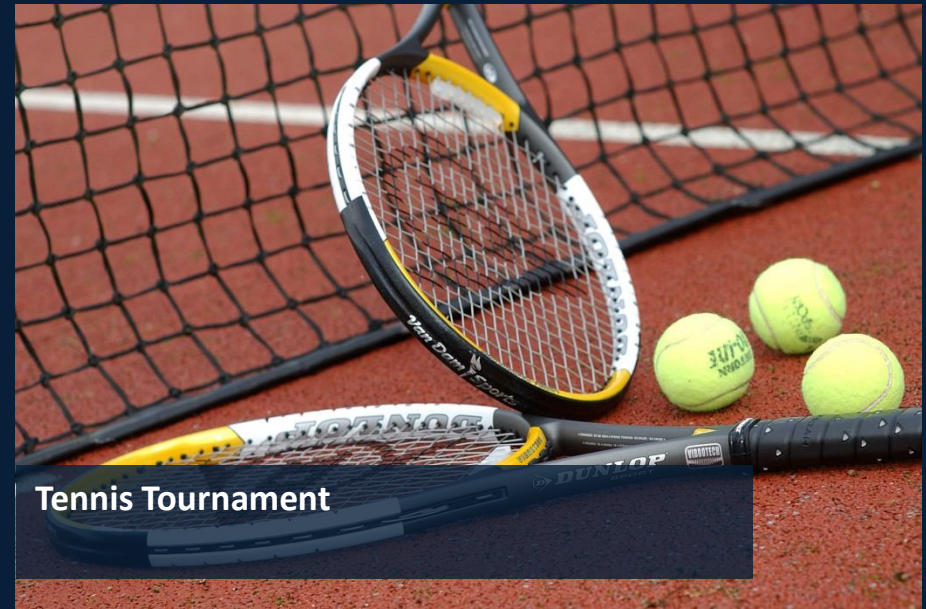

Tennis Tournament





**Bootcamp**

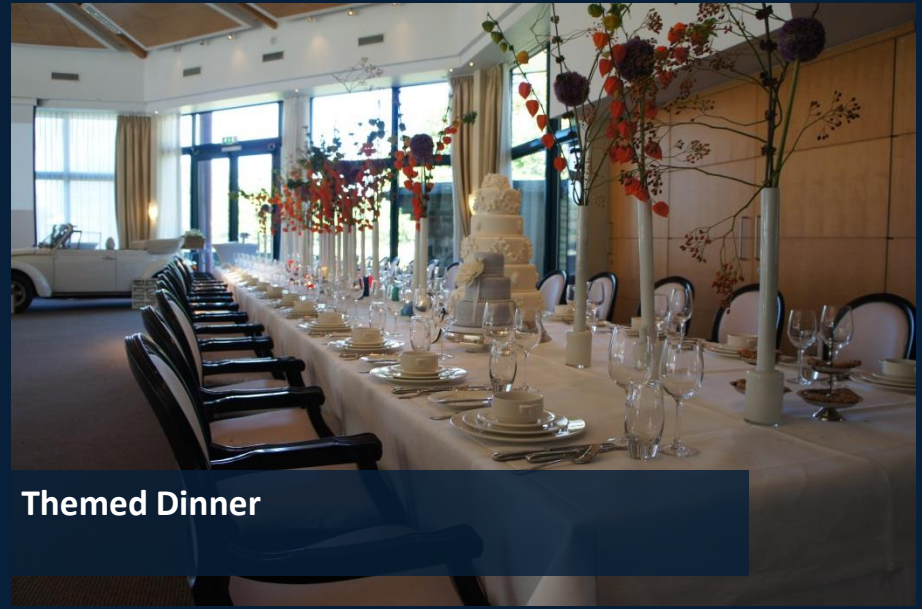

**Themed Dinner**



**Themed Evening Party**



**Out of the ordinary meeting surroundings**





**Car Launch (product presentation)**



**Concert**



**Speak Easy**



**Culinary Workshop**





Seminar



The Paltz Estate



Fashion Show



Training

# CONTACT PERSONS

## HILTON ROYAL PARC SOESTDUINEN

### **Groups, Conference & Events Team**

**Hilton Royal Parc Soestduinen**

E: [cb.soestduinen@hilton.com](mailto:cb.soestduinen@hilton.com)

T: +31 35 603 83 88

### **Hotel Manager**

**Mrs. Frederieke Boomsma**

E: [frederieke.boomsma@hilton.com](mailto:frederieke.boomsma@hilton.com)

T: +31 6 51 22 47 28

### **Sales Executive Hilton Royal Parc Soestduinen**

**Mr. Sam Christ**

E: [sam.christ@hilton.com](mailto:sam.christ@hilton.com)

T: +31 6 51 85 23 87

### **Director of Sales - The Netherlands**

**Mr. Guy Stolk**

E: [guy.stolk@hilton.com](mailto:guy.stolk@hilton.com)

T: +31 6 20 54 37 01